

Pilares que nascem em Terreo e chegam em Cobertura
 Concreto: C35 em geral
 Aço das barras: CA-50 e CA-60
 Aço dos estribos: CA-50 e CA-60

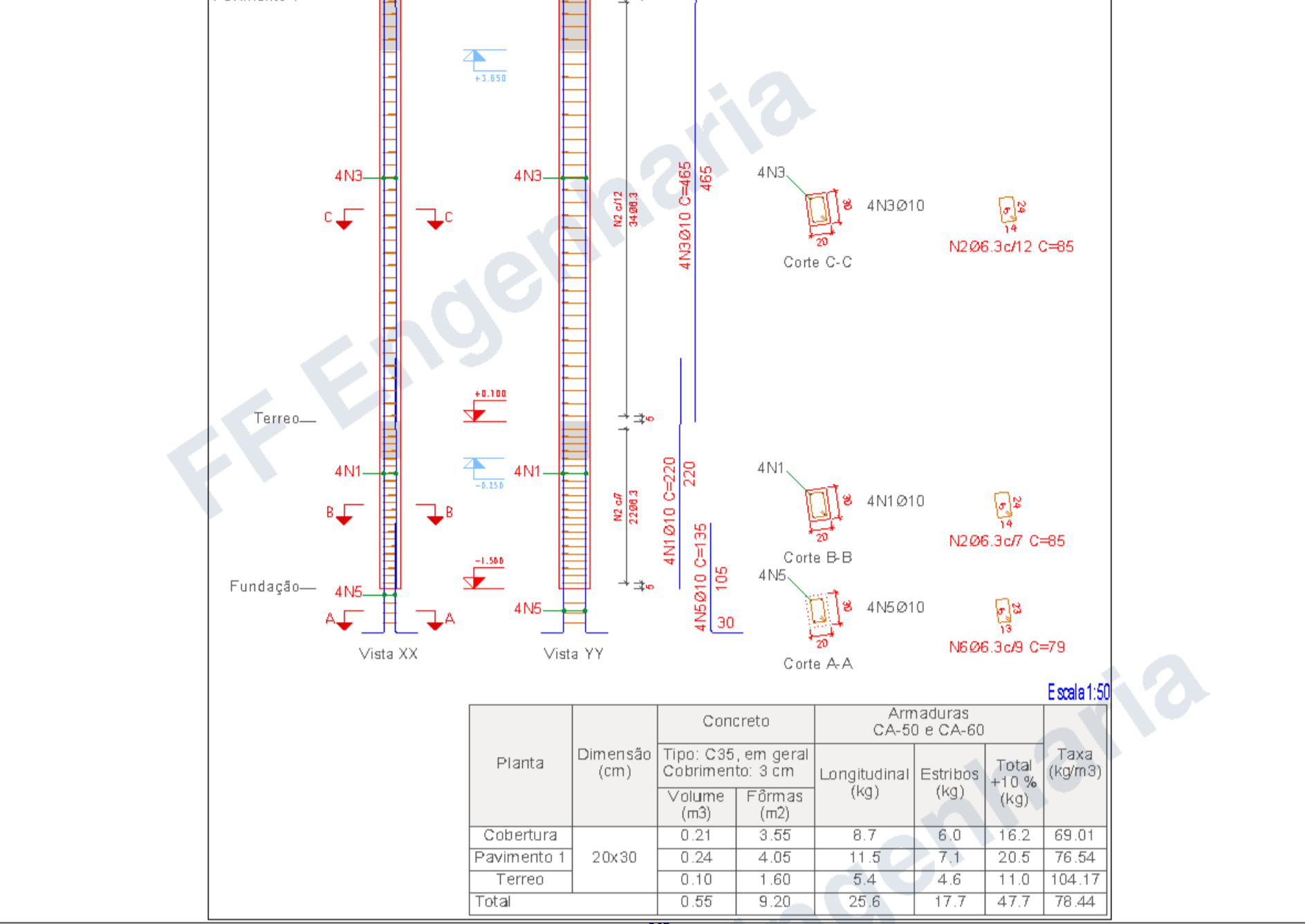

Elemento	Pos.	Diam.	Q.	Esquema (cm)	Comp. (cm)	Total (cm)	CA-50 (kg)	CA-60 (kg)			
P20	1	Ø10	6		190	1140	7.0				
	2	Ø6.3	76		95	7220	17.7				
	3	Ø6.3	76		21	1596	3.9				
	4	Ø10	6		465	2790	17.2				
	5	Ø10	6		352	2112	13.0				
	6	Ø10	6		116	696	4.3				
	7	Ø6.3	3		87	261	0.6				
Total+10%									70.1		
P21	1	Ø10	4		190	760	4.7				
	2	Ø6.3	76		85	6460	15.8				
	3	Ø10	4		465	1860	11.6				
	4	Ø10	4		352	1408	8.7				
	5	Ø10	6		100	400	2.5				
	6	Ø6.3	3		79	237	0.6				
	Total+10%									48.2	
P22	1	Ø10	6		190	1140	7.0				
	2	Ø6.3	76		75	5700	14.0				
	3	Ø10	4		465	1860	11.5				
	4	Ø10	4		352	1408	8.7				
	5	Ø10	6		96	576	3.5				
	6	Ø10	6		100	400	2.5				
	7	Ø6.3	3		67	201	0.5				
Total+10%									56.0		
P23	1	Ø10	4		190	760	4.7				
	2	Ø6.3	47		85	3995	9.8				
	3	Ø10	4		465	1860	11.5				
	4	Ø10	4		352	1408	8.7				
	5	Ø6.3	29		75	2175	5.3				
	6	Ø10	4		100	400	2.5				
	7	Ø6.3	3		79	237	0.6				
Total+10%									47.4		
P24	1	Ø12.5	6		200	1200	11.6				
	2	Ø6.3	67		75	5025	12.3				
	3	Ø12.5	4		465	1860	17.9				
	4	Ø12.5	2		445	890	9.6				
	5	Ø10	4		352	1408	8.7				
	6	Ø12.5	6		140	840	8.1				
	7	Ø6.3	3		65	195	0.5				
Total+10%									74.5		
P25	1	Ø10	4		190	760	5.4				
	2	Ø6.3	85		85	7220	17.7				
	3	Ø6.3	76		21	1596	3.9				
	4	Ø10	6		465	2790	17.9				
	5	Ø10	6		352	2112	13.0				
	6	Ø10	6		125	750	3.3				
	7	Ø6.3	3		79	237	0.6				
Total+10%									51.9		
P26	1	Ø16	4		200	800	13.3				
	2	Ø6.3	11		85	935	2.3				
	3	Ø10	4		465	1860	11.5				
	4	Ø6.3	34		85	2890	7.1				
	5	Ø10	4		352	1408	8.7				
	6	Ø6.3	29		75	2175	5.3				
	7	Ø16	4		100	720	11.4				
8	Ø6.3	3		76	228	0.6					
Total+10%									66.8		
P27	1	Ø10	6		190	1140	7.0				
	2	Ø6.3	76		95	7220	17.7				
	3	Ø6.3	76		21	1596	3.9				
	4	Ø10	6		465	2790	17.2				
	5	Ø10	6		352	2112	13.0				
	6	Ø10	6		125	750	4.6				
	7	Ø6.3	3		87	261	0.6				
Total+10%									70.4		
P28	1	Ø10	6		190	1140	7.0				
	2	Ø6.3	76		95	7220	17.7				
	3	Ø6.3	76		21	1596	3.9				
	4	Ø10	6		465	2790	17.2				
	5	Ø10	6		352	2112	13.0				
	6	Ø10	6		125	750	4.6				
	7	Ø6.3	3		87	261	0.6				
Total+10%									72.3		
Total									86.3	0.0	
									915.3	0.0	
									Ø12.5	59.8	0.0
									Ø16	27.0	0.0
									Total	257.7	0.0

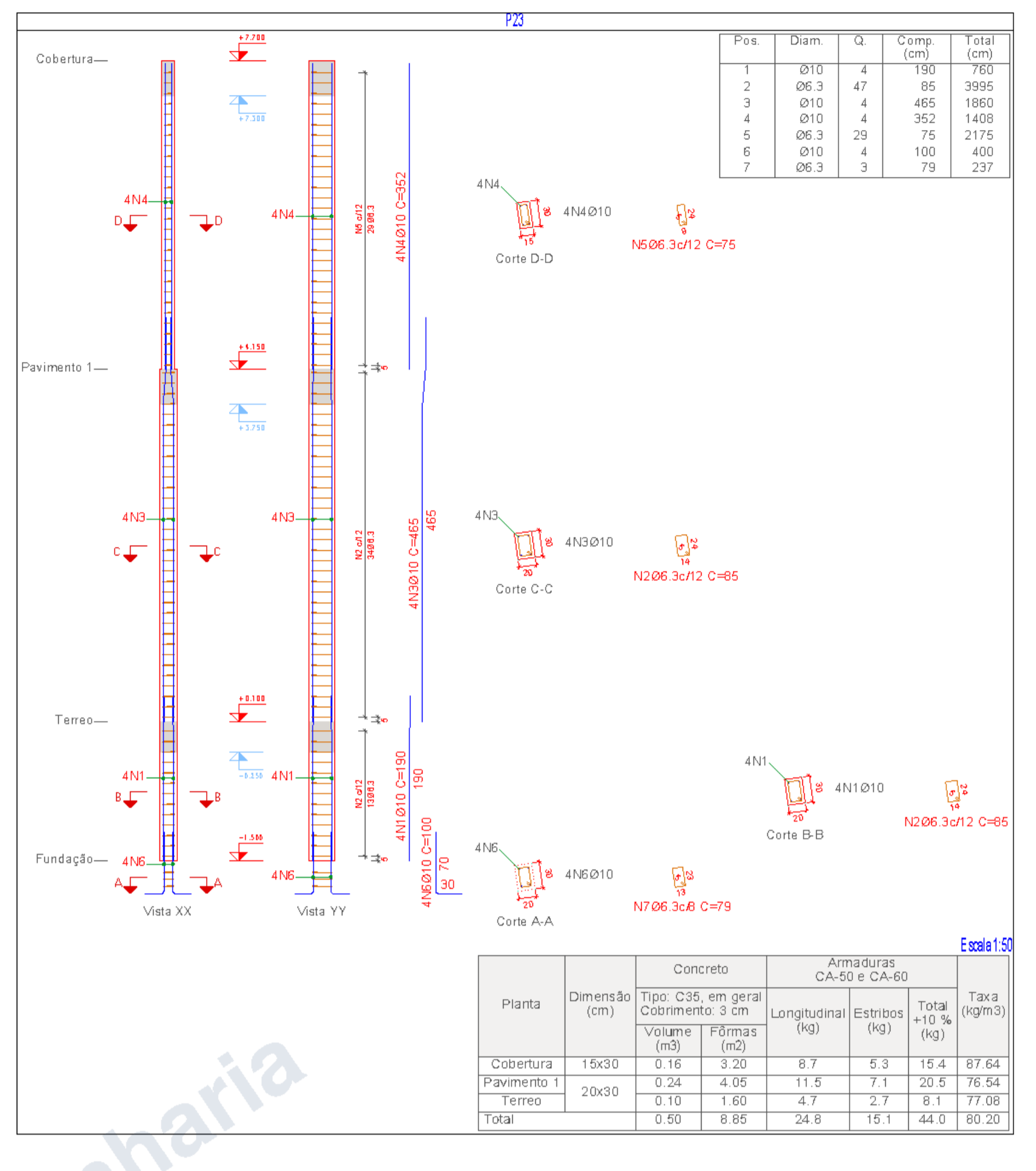
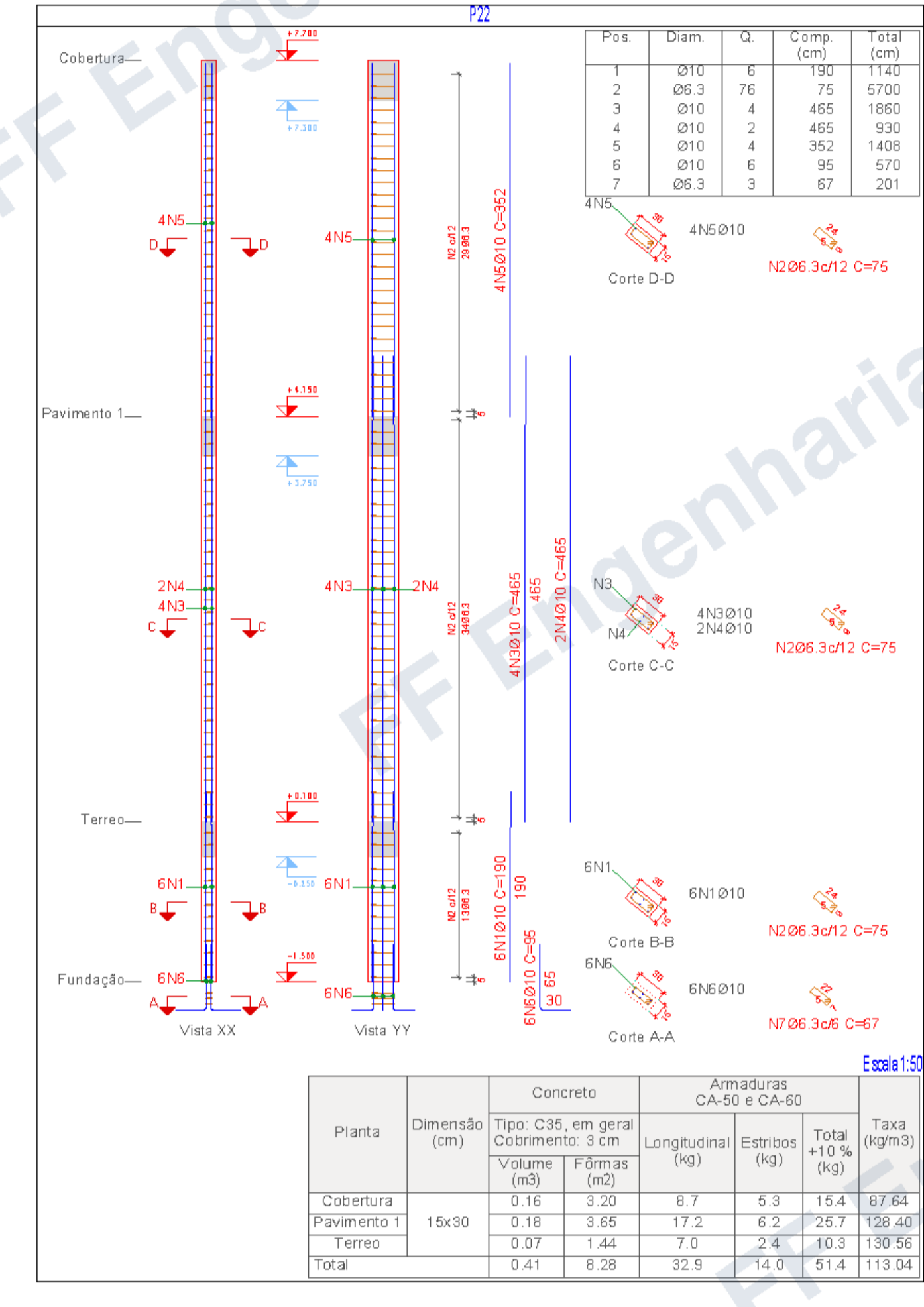
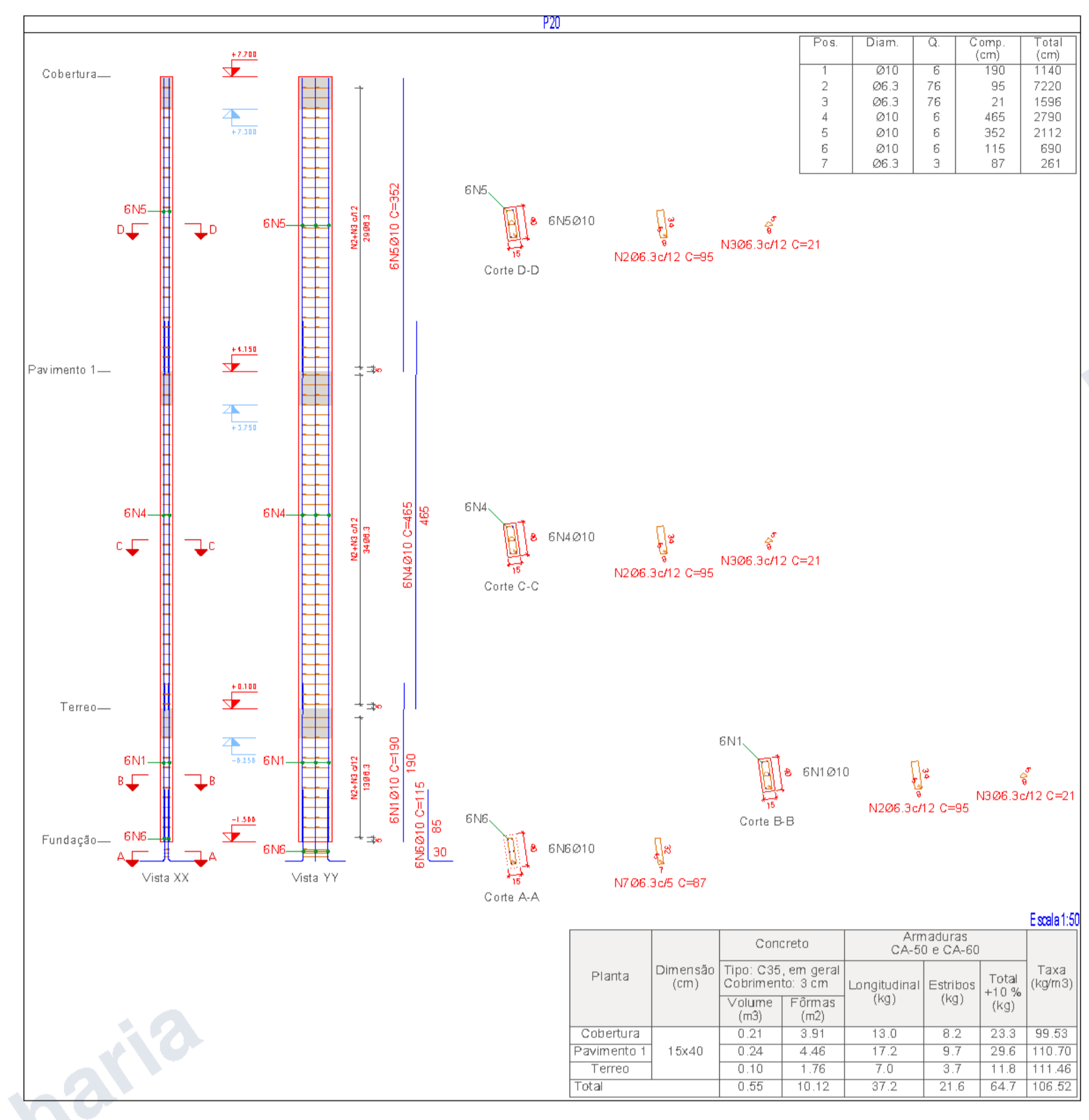