

VIGAS PAV 1 F02

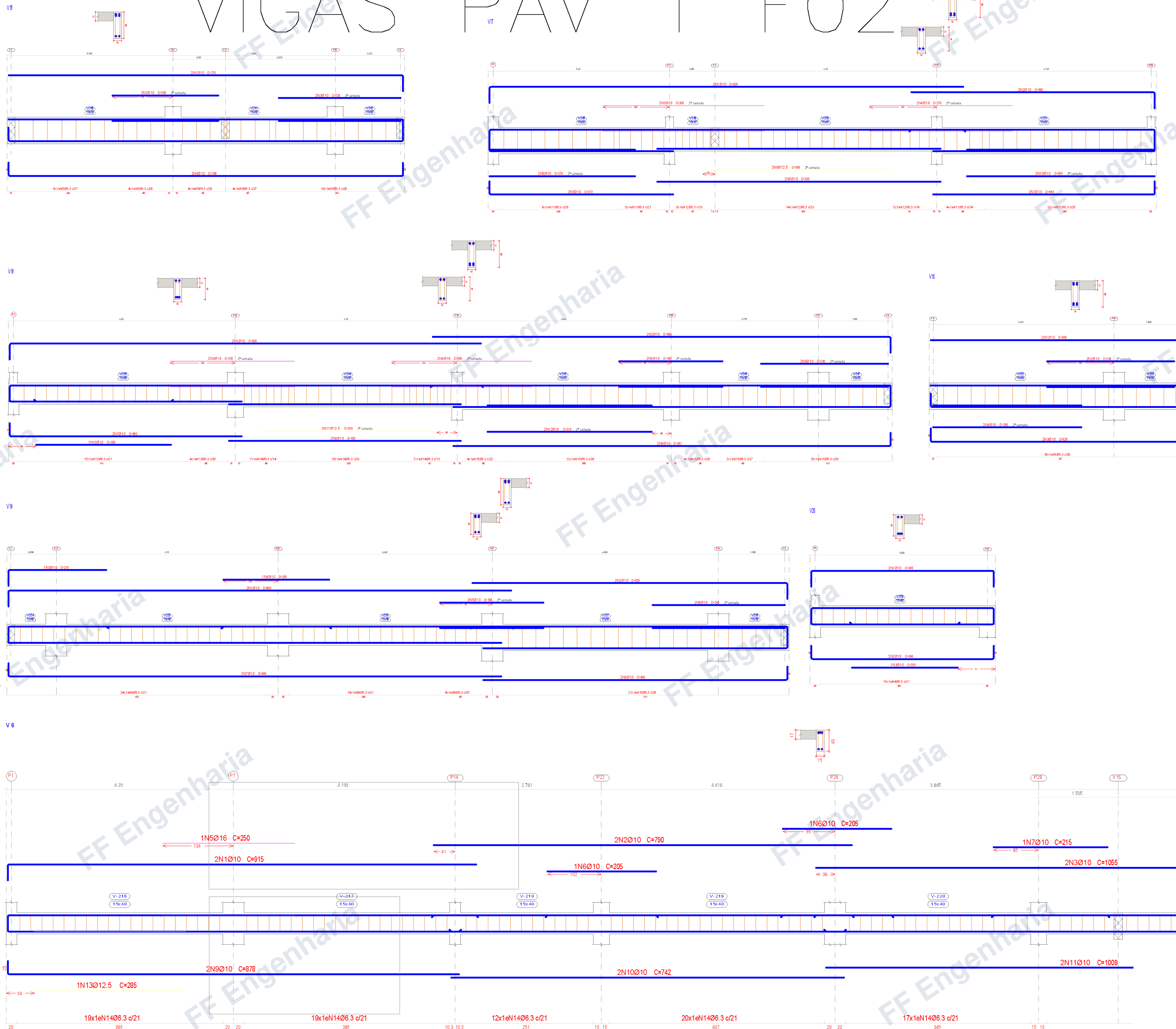

Pavimento 1
 Desenho de vigas
 Concreto C25, em geral
 Apo das barras: CA-50 e CA-60
 Apo dos estribos: CA-50 e CA-60
 Escala seções 1:25
 Escala aberturas 1:25

Elemento	Pos.	Diam.	Q.	Esquema (cm)	Comp (cm)	Total (cm)	CA-50 (kg)	CA-60 (kg)	
V15	1	Ø10	2	285	915	1830	11.3		
	2	Ø10	2	235	790	1580	9.7		
	3	Ø10	2	1655	1055	2110	13.0		
	4	Ø10	2	460	460	920	5.7		
	5	Ø16	1	250	250	250	3.9		
V16	6	Ø10	2	205	205	410	2.6		
	7	Ø10	1	215	215	215	1.3		
	8	Ø10	1	255	255	255	1.6		
	9	Ø10	2	853	878	1756	10.8		
	10	Ø10	2	742	742	1484	9.1		
	11	Ø10	2	1009	1009	2018	12.4		
	12	Ø10	2	456	456	912	5.6		
	13	Ø12.5	1	285	285	285	2.7		
	14	Ø8.3	133	96	96	12768	31.3		
Total+10%:							133.0	0.0	
							Ø6.3:	34.4	0.0
							Ø10:	91.3	0.0
							Ø12.5:	3.0	0.0
							Ø16:	4.3	0.0
Total:							133.0	0.0	

Elemento	Pos.	Diam.	Q.	Esquema (cm)	Comp (cm)	Total (cm)	CA-50 (kg)	CA-60 (kg)	
V6	1	Ø10	2	885	915	1830	11.3		
	2	Ø10	2	790	790	1580	9.7		
	3	Ø10	2	1055	1055	2110	13.0		
	4	Ø10	2	460	460	920	5.7		
	5	Ø16	1	250	250	250	3.9		
	6	Ø10	2	205	205	410	2.6		
	7	Ø10	1	215	215	215	1.3		
	8	Ø10	1	255	255	255	1.6		
	9	Ø10	2	853	878	1756	10.8		
	10	Ø10	2	742	742	1484	9.1		
	11	Ø10	2	1009	1009	2018	12.4		
	12	Ø10	2	456	456	912	5.6		
	13	Ø12.5	1	285	285	285	2.7		
	14	Ø8.3	133	96	96	12768	31.3		
Total+10%:							133.0	0.0	
							Ø6.3:	34.4	0.0
							Ø10:	91.3	0.0
							Ø12.5:	3.0	0.0
							Ø16:	4.3	0.0
Total:							133.0	0.0	